

MIKE SHERWOOD

PEARL LAB MANAGER

Responsibilities

- Card Access for Work Areas & Breakout Rooms
- Safety Review of Projects and Work Areas

Duties

- Assign Project work area
- Help with Questions on Design and Materials
- Safety
- Welding of Projects with a 4 hour max per group
- Some Rapid Prototyping of Parts

My Background

- M.E. Research Machinist and Welder for 30 Plus Years

Contact

- E-Mail: msherwoo@purdue.edu
Office rm 1180

Safety

Safety Reviews :

- There will be 3 safety reviews on your project. All reviews will be e-mailed to myself msherwoo@purdue.edu, Professor Nelson tnelson1@purdue.edu and your instructor. Accepted formats are Word or PDF documents only. Approval to proceed will come from me.
- SR1 is due in week 3 concept phase.
- SR2 is due in week 7 final design phase.
- SR3 is **Only due when your project is completed and ready for testing!** I must see your project before you can start testing.

Work Room Safety:

- Safety glasses are to be worn by you and others around you while working with power tools or hand tools that generate air borne debris in Rooms 1202, 1203 and 1178.
- No open toe shoes are to be worn in the work rooms (1202, 1203, 1178)
- A Safety Data Sheet (SDS) is required for any chemical brought into this lab. Please Give a copy to the Lab Manager.

Access & Safety

Test that Must be Taken:

- **M.E. Building Emergency Plan Quiz (BEP)**
<https://engineering.purdue.edu/ME/InfoFor/BuildingSafety>
This Test must be passed in order to get access to PEARL Breakout Rooms 24/7, Work Rooms 7:00am - 11:50pm and After hours Building Access.

Optional Tests if you plan on using these facilities.

- **M.E. Project Machine Shop Quiz**
<https://engineering.purdue.edu/MECL/projectshop/>
This must be passed before you can gain access to the Machine shop.
- **M.E. 3D Print Lab Quiz for after hours access.**
<https://engineering.purdue.edu/MECL/3dprint/>

Available Resources For checkout from my office

- ▣ Basic Tool Bags



- ▣ Large Tool Kits



Available Resources For checkout from my office

- ▣ Cordless Drills
- ▣ Small Drill Bit Set



- ▣ Batteries : Sealed Lead Acid, LiPo, NiMH and Li-ion
- ▣ Radio control units
- ▣ Misc. R/C components Motors, ESC & Props.
- ▣ NextEngine desktop 3D Scanner

Resources In The Labs Rooms 1202 & 1203

- ▣ Motors of all types AC, DC & Stepper
- ▣ Bulk wire
- ▣ Switches, buttons, Relays
- ▣ Sprockets, Gears, Pulleys, Belts & Chains
- ▣ Pillow Block bearings
- ▣ Wheels & Castors
- ▣ Misc. Other Materials Hardware & Electrical
- ▣ Fume Hood for gluing, Fiber glassing & Lite Painting Must See Me Before Use

These are the Only Storage Areas where Components are available Free for the taking



- ▣ Room 1202

These are the Only Storage Areas where Components are available Free for the taking



□ Room 1203



- ❑ Do Not Take Parts From Benches Or Storage Cubbies In Rooms 1202 & 1203 they belong to other 463 Groups!

Additional Work Area For All M.E. Students Room 2130



- ❑ Soldering Station
- ❑ Test Equipment
- ❑ Work Station for Programing Arduino's
- ❑ Additional Electrical Component's

RULES FOR PAINTING PROJECTS HERE AT MECHANICAL ENGINEERING

No Spray Painting Is Allowed In The Building Except In One Of
Two Fume Hoods!

These hoods are to be used on small projects. Heavy spray painting
needs to be done outside in the designated area only.

If you have any Questions Please Contact:

Mike Sherwood room 1180

Or

Rick DuVall room G044

The First Hood Is In Room G039 Student Shop

This Hood Can Be Used By All M.E. Students.
Talk To Shop Staff Before Use.



The Second Hood Is In Room 1202 PEARL Labs

This Hood Is For Senior design Use Only.
Contact: Mike Sherwood Before Use.



This Is Where Not To Spray Paint!

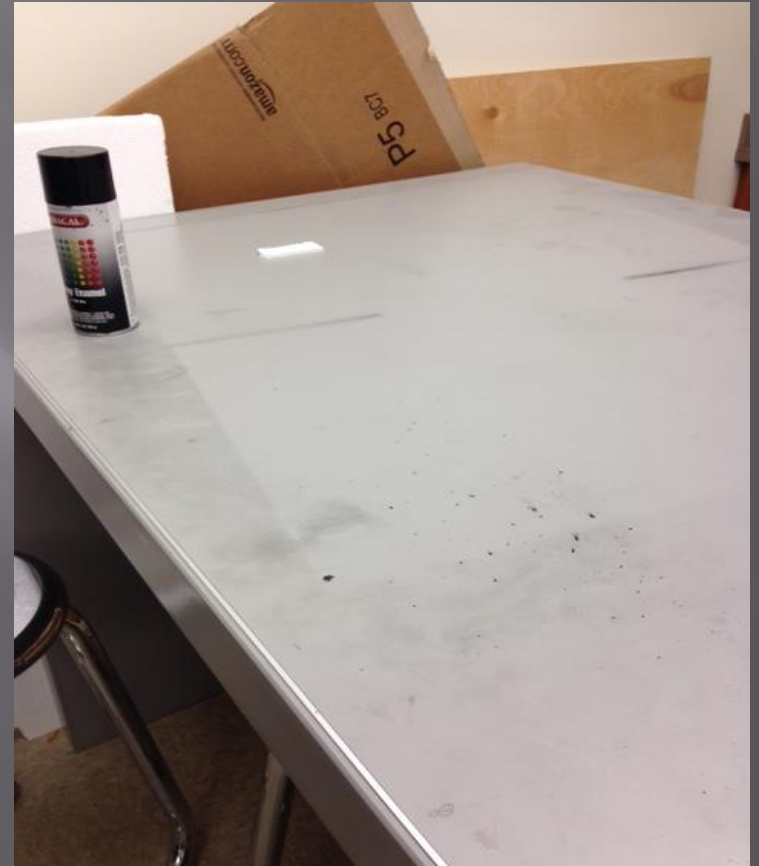

Room 2130

This Is Also Where Not To Spray Paint!



Outside Designated Painting Area Location



Back Entrance M.E. Building Next To Loading Dock



Paint Here On Gravel

Painting Is Allowed On The Gravel Area Just Past The Green High Voltage Box On The Left



Please Paint in the middle of the rocks and away from the sides of the building.

Brush Painting Is Allowed In The Building As Long As Proper Procedures Are Followed

1. Only Low Oder paints should be used. Read label first if it says use in adequate ventilation then it needs to be used in a fume hood or outside.
2. Proper protection for tables and floor where you will be painting. Use Cardboard a Drop cloth or News Paper to protect surfaces.
3. Large projects need to be painted outside in designated area. If it is larger than a microwave oven then it needs to be painted outside.

I am here as a resource so please ask Questions !

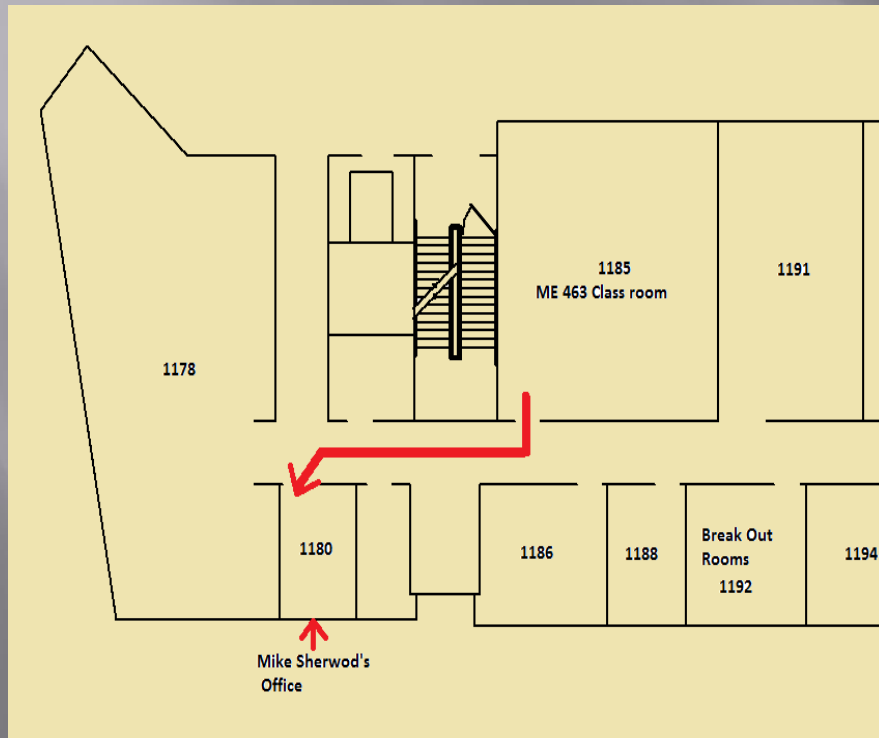

Contact
Mike Sherwood
Room 1180
msherwoo@purdue.edu